

Bushings for Locating Pins

Straight/with Shoulder Anti-Shedding Type

Straight

Code	Type	Tolerance Grade	Material		Hardness	Surface Treatment
			GB	Equiv.		
YEL01	Straight	D _{m6}	9CrWMn	SKS3	54~58HRC	—
YEL03				SUS440C		Electroless Nickel Plating
YEL11				SUS440C		—
YEL21	Straight	D _{p6}	9CrWMn	SKS3	54~58HRC	—
YEL23				SUS440C		Electroless Nickel Plating



Part Number		D Tol.		0.01 mm Inc.		0.1 mm Inc.		R
Code	D	m6	p6	P	L			
D _{m6}	8	+0.015	+0.024	4.00~4.50	10.0~15.0			1.0
	10	+0.006	+0.015	4.00~6.50	10.0~22.0			
	12			6.00~8.50				
	15	+0.018	+0.029	8.00~10.50				2.0
	18	+0.007	+0.018	10.00~12.50				
20			12.00~13.50	10.0~42.0				
22			12.00~13.50					
25	+0.021	+0.035	13.00~15.50					
D _{p6}	26	+0.008	+0.022	15.00~16.50				3.0
	30			16.00~20.50	12.0~62.0			
	35	+0.025	+0.042	20.00~25.00				
		+0.009	+0.026					

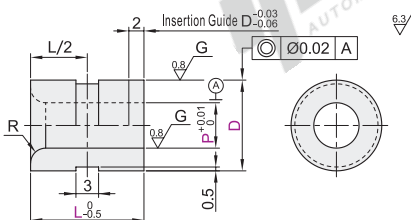

Code	Spec.
HA	Set Screw Groove Depth

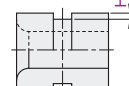

Ordering Code HA
Changes the depth of set screw groove to depth 1.0 mm.
D < 18 not applicable.



Please order as shown

Part Number	D Tol.	0.01 mm Inc.	0.1 mm Inc.
YEL01	D10	4.00~5.50	10.0~22.0
YEL03	12	6.00~8.50	

YEL01-D10-P4-L12

Optional Processing

Part Number	D Tol.	0.01 mm Inc.	0.1 mm Inc.	Optional Processing Code
YEL01	D10	4.00~5.50	10.0~22.0	HA
YEL03	12	6.00~8.50		

YEL01-D10-P5-L15-HA



Discount price
Per 1~4 5~
Price 100% Additional quotation



Surface Free Treatment



Surface Finish

with Shoulder

Code	Type	Tolerance Grade	Material		Hardness	Surface Treatment	
			GB	Equiv.			
YEL41	with Shoulder	D _{m6}	9CrWMn	SKS3	54~58HRC	—	
YEL51			9Cr18Mo	SUS440C			48~53HRC
YEL61			9CrWMn	SKS3			54~58HRC

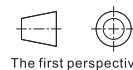
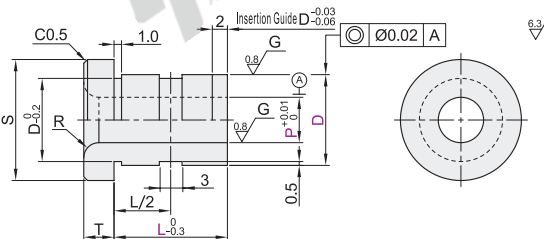

Part Number		D Tol.		0.01 mm Inc.		0.1 mm Inc.		R	S	T
Code	D	m6	p6	P	L					
D _{m6}	8	+0.015	+0.024	4.00~4.50	8.0~12.0			1.0	12	3
	10	+0.006	+0.015	4.00~6.50	8.0~17.0					
	12			6.00~8.50						
	15	+0.018	+0.029	8.00~10.50						
YEL41	18	+0.007	+0.018	10.00~12.50				2.0	19	4
	20			12.00~13.50	10.0~37.0					
	22			12.00~13.50						
D _{p6}	25	+0.021	+0.035	13.00~15.50				3.0	26	5
	26	+0.008	+0.022	15.00~16.50						
	30			16.00~20.50						
	35	+0.025	+0.042	20.00~25.00	12.0~52.0					
		+0.009	+0.026							



Code	Spec.
HA	Set Screw Groove Depth

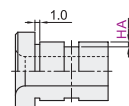

Ordering Code HA
Changes the depth of set screw groove to depth 1.0 mm.
D < 18 not applicable.



Please order as shown

Part Number	D Tol.	0.01 mm Inc.	0.1 mm Inc.
YEL41	D10	4.00~5.50	8.0~17.0
YEL51	12	6.00~8.50	

YEL41-D10-P5-L15

Optional Processing

Part Number	D Tol.	0.01 mm Inc.	0.1 mm Inc.	Optional Processing Code
YEL41	D10	4.00~5.50	8.0~17.0	HA
YEL51	12	6.00~8.50		

YEL41-D10-P5-L15-HA



Discount price
Per 1~9 10~
Price 100% Additional quotation



Surface Free Treatment