

T-Shaped Handle

Code	Type	Material			Surface Treatment			Reference Weight (kg)
		Housing	Handle	Cam	Housing	Handle	Cam	
XAR21	T-Shaped Handle With Cylinder Lock	ZDC		Q235	Pocked black power coated	Zinc-plated		0.196

Features:

- The handle is convenient for holding and opening the door;
- Rotate the handle by 90° to open or lock the door;
- In common use both for left-opening and right-opening;
- IP protection grade Ip65.

! The hole size of the lock tongue: □ 8×8;

! Accessories: 2 keys.



Cut Out Dimensions

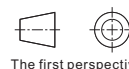
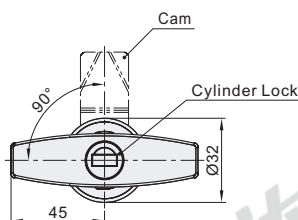
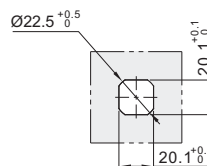
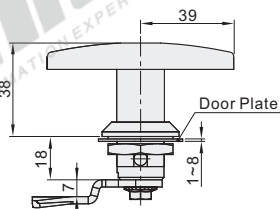

The first perspective

L-Shaped Handle

Code	Type	Groundwork Height	Cylinder Lock	Material			Surface Treatment		
				Housing	Handle	Cam	Housing	Handle	Cam
XAR26	L-Shaped Handle	31	No Cylinder Lock	ZDC5	ZDC5	S45C	Bright chrome plated	Blue and white zinc plated	

Features:

- Rotate the handle by 90° to open or lock the door;
- In common use both for left-opening and right-opening.

! The hole size of the lock tongue: □ 8×8;

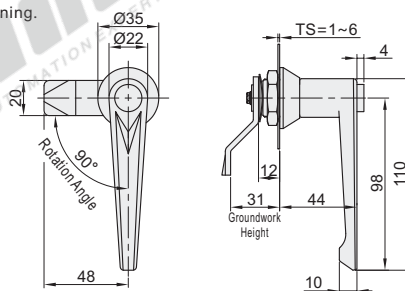

Cut Out Dimensions

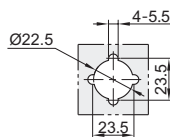

The first perspective

Code	Reference Weight(kg)
XAR26	0.141



Please order as shown

Code
XAR21
XAR26
XAR21



Discount price	
Per	Price
1~4	100%
5~	Additional quotation



Delivery
6