

# Flexible Eye Bolt

Code	Type	Material	Surface Treatment
TCC16	Flexible Eye Bolt	Alloy Steel	Baked Paint

Product upgrade bolt performance is upgraded from black to silver Geomet, Which does not affect the quality and is replaced naturally. There may be two types of bolts in the same batch.

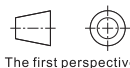
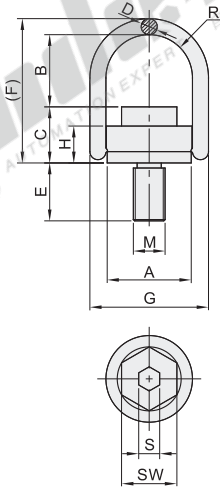

Due to the baking varnish process, hoisting part area may not be painted.

Part Number	Safety Coefficient	Locking Torque (N/m)	M	A	B	C	D	E	F	G	H	R	S	SW	Net Weight (kg)	
TCC16	0.5T	4	30	8	42	28		12						13	0.3	
	0.7T		60	10	33	41	29	11	15	80	58	23	17	6		17
	1.0T		100	12		40	31		18					8		19
	1.5T		120	14	51	56	45	17	21	117	90	36	27	10		22
	2.0T		150	16		54	46		24							24
	2.5T		200	18	65	78	57	20	27	153	108	44	34	12		30
	3.0T		250	20	51	52	49	17	30	117	90	36	27			1
	5.0T		400	24	72	81	59	22	36	162	125	44	37	14		36

## Working Load Limit

Hanging Ring Way To Install	Working Load Limit(T)											
	1	2	1	2	2	2	2	3~4	3~4	3~4	3~4	
Number of Legs	1	2	1	2	2	2	2	3~4	3~4	3~4	3~4	
Load Direction	0°	0°	90°	90°	0~45°	45~60°	Asymmetry	0~45°	45~60°	Asymmetry	Asymmetry	
Part Number	Thread	Working Load Limit(T)										
TCC16	0.5T	M8	0.8	1.6	0.5	1	0.7	0.5	0.5	1.1	0.8	0.5
	0.7T	M10	1.2	2.4	0.7	1.4	1	0.7	0.7	1.5	1.1	0.7
	1.0T	M12	2	4	1	2	1.4	1	1	2.1	1.5	1
	1.5T	M14	2.4	4.8	1.5	3	2.1	1.5	1.5	3.2	2.3	1.5
	2.0T	M16	3.2	6.4	2	4	2.8	2	2	4.2	3	2
	2.5T	M18	5	10	2.5	5	3.5	2.5	2.5	5.3	3.8	2.5
	3.0T	M20	5.6	11.2	3	6	4.2	3	3	6.3	4.5	3
	5.0T	M24	9.2	18.4	5	10	7	5	5	10.5	7.5	5



Part Number	Safety Coefficient
TCC16	4



Discount price
Per 1~19 20~
Price 100% Additional quotation



Delivery
4

TCC16-0.5T

