

One End Tapped/One End Threaded Both Ends Tapped, L Configurable

Circular Posts

One End Tapped/One End Threaded

With Wrench Flats		Material		Surface Treatment	L	Tolerance
One End Tapped	One End Threaded	GB	Equiv.			
RAC03	RAC13	Q235	SS400	Electroless Nickel Plating	15-300	±0.2
RAC06	RAC16	0Cr18Ni9	SUS304	—	301-600	±0.3
					601-1020	±0.4



One End Tapped
RAC03/06

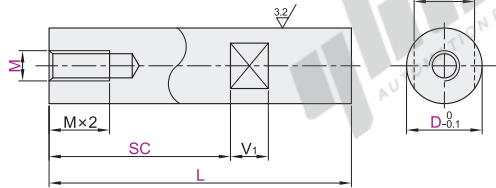

One End Threaded
RAC13/16

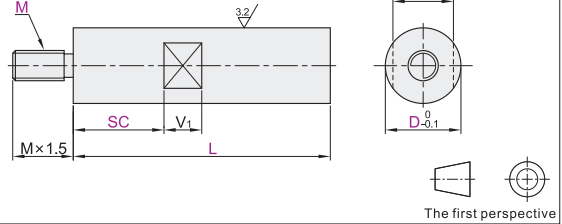

Anti-rust Oil is applied on Q235 or Equivalent products.

The first perspective

Part Number	1 mm Inc.			M (Coarse)	W	V ₁
	Code	D	SC			
One End Tapped	RAC03	5	15-60	0-50	2.6 3	4
	RAC06	6	20-160	0-150	3 4 5	5
		8	20-360	0-350	4 5 6	7
		10	25-420	0-398	5 6 8	8
		12	35-520	0-508	6 8 10 12	10
One End Threaded	RAC13	15	40-520	0-608	6 8 10 12 16	12
	RAC16	20	55-620	0-705	6 8 10 12 16 20	16
		25	65-720	0-805	8 10 12 16 20	20
		30	80-820	0-900	10 12 16 20 24	24
		35	80-920	0-1000	12 16 20 24	28
		40	80-1020		12 16 20 24	32
		50			12 16 20 24	41



Code	Spec.
MC ()	<p>Changes The Threaded Length</p> <p>Ordering Code MC4</p> <ul style="list-style-type: none"> 0.1 mm Inc. Not applicable to One End Tapped. Not applicable to D=5. Mx1 ≤ MC < Mx1.5

Discount price	Per	1~4	5~
Price	100%	Additional quotation	

Delivery	6
----------	---



One End Tapped

Part Number	1 mm Inc.			M
Code	D	L	SC	M
RAC03	5	15-60	0-50	2.6 3
RAC06	6	20-160	0-150	3 4

RAC06 — D5 — L50 — SC15 — M2.6

Optional Processing (One End Threaded)

Part Number	1 mm Inc.			M	Optional Processing
Code	D	L	SC	M	Code
RAC13	5	15-60	0-50	2.6 3	MC ()
RAC16	6	20-160	0-150	3 > 4	MC ()

RAC16 — D6 — L50 — SC15 — M3 — MC4

Both Ends Tapped

L Configurable		Material		Surface Treatment	L	Tolerance
Standard	with Wrench Flats	GB	Equiv.			
RAD03	RAD13	Q235	SS400	Electroless Nickel Plating	8-300	±0.2
RAD06	RAD16	0Cr18Ni9	SUS304	—	300.5-600	±0.3
RAD08	RAD18	LY11	A2017	Clear Anodize	600.5-1020	±0.4



Standard
RAD03/06/08

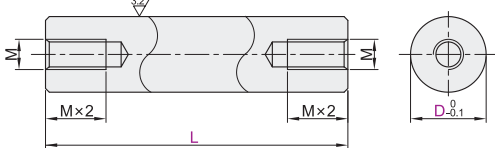

with Wrench Flats
RAD13/16/18

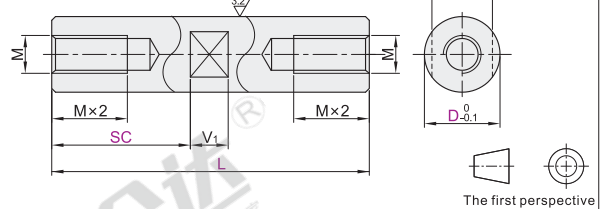

Anti-rust Oil is applied on Q235 or Equivalent products.

The first perspective

Part Number	0.5 mm Inc.		M (Coarse)	W	V ₁
	Code	L			
Standard	RAD03	5	8.0-60.0	2.6	4
	RAD06	6	10.0-160.0	3	5
	RAD08	8	15.0-360.0	4	7
		10	25.0-420.0	5	8
		12	25.0-520.0	6	10
		15	30.0-520.0	8	12
		20	40.0-620.0	10	17
		25	50.0-720.0	12	22
		30	50.0-820.0	16	27
		35	60.0-920.0	20	36
	40	75.0-1020.0	24	41	

Part Number	0.5 mm Inc.		1 mm Inc.	M (Coarse)	W	V ₁
	Code	L				
with Wrench Flats	RAD13	5	10.0-60.0	0-50	2.6	4
	RAD16	6	10.0-160.0	0-150	3	5
	RAD18	8	15.0-360.0	0-350	4	7
		10	25.0-420.0	0-408	5	8
		12	25.0-520.0	0-508	6	10
		15	30.0-520.0	0-610	8	13
		20	40.0-620.0	0-705	10	17
		25	50.0-720.0	0-805	12	22
		30	50.0-820.0	0-900	16	27
		35	60.0-920.0	0-1000	20	36
	40	75.0-1020.0		24	41	



with Wrench Flats

Part Number	0.5 mm Inc.		1 mm Inc.
Code	D	L	SC
RAD13	5	10-60	0-50
RAD16	6	10-160	0-150

RAD16 — D6 — L60 — SC25



Discount price	Per	1~4	5~
Price	100%	Additional quotation	



Delivery	6
----------	---