

# One End Tapped/One End Threaded Both Ends Tapped, L Configurable

# Circular Posts

## One End Tapped/One End Threaded

With Wrench Flats		Material		Surface Treatment	L	Tolerance
One End Tapped	One End Threaded	GB	Equiv.			
RAC03	RAC13	Q235	SS400	Electroless Nickel Plating	15-300	±0.2
RAC06	RAC16	0Cr18Ni9	SUS304	—	301-600	±0.3
					601-1020	±0.4



### One End Tapped RAC03/06

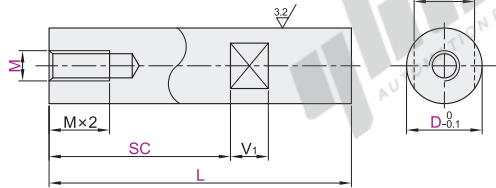

### One End Threaded RAC13/16

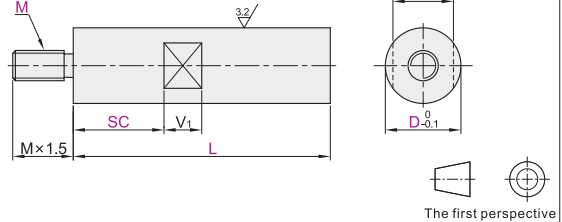

Anti-rust Oil is applied on Q235 or Equivalent products.

The first perspective

Part Number Code	1 mm Inc.			M (Coarse)	W	V1
	D	L	SC			
One End Tapped RAC03 RAC06	5			2.6 3	4	10
	6	15-60	0-50	3 4	5	10
	8	20-160	0-150	3 4 5	7	10
	10	20-360	0-350	4 5 6	8	10
One End Threaded RAC13 RAC16	12	25-420	0-398	5 6 8	10	10
	15	35-520		6 8 10	13	12
	20	40-520	0-508		6 8 10 12	17
	25	55-620	0-608		6 8 10 12 16	22
	30	65-720	0-705		6 8 10 12 16 20	27
	35	80-820	0-805		8 10 12 16 20	30
	40	80-920	0-900		10 12 16 20 24	36
	50	80-1020	0-1000		12 16 20 24	41



Code	Spec.
MC ( )	<b>Changes The Threaded Length</b> Ordering Code <b>MC4</b> 0.1 mm Inc. Not applicable to One End Tapped. Not applicable to D=5. Mx1 ≤ MC < Mx1.5

Discount price	Delivery
Per 1~4 5~ Price 100% Additional quotation	6



## One End Tapped

Part Number Code	1 mm Inc.		M
D	L	SC	
RAC03	5		2.6 3
RAC06	6	15-60	3 4

RAC06 — D5 — L50 — SC15 — M2.6

## Optional Processing (One End Threaded)

Part Number Code	1 mm Inc.		M	Optional Processing Code
D	L	SC		
RAC13	5		2.6 3	MC ( )
RAC16	6	15-60	3 > 4	MC4

RAC16 — D6 — L50 — SC15 — M3 — MC4

## Both Ends Tapped

L Configurable		Material		Surface Treatment	L	Tolerance
Standard	with Wrench Flats	GB	Equiv.			
RAD03	RAD13	Q235	SS400	Electroless Nickel Plating	8-300	±0.2
RAD06	RAD16	0Cr18Ni9	SUS304	—	300.5-600	±0.3
RAD08	RAD18	LY11	A2017	Clear Anodize	600.5-1020	±0.4



### Standard RAD03/06/08

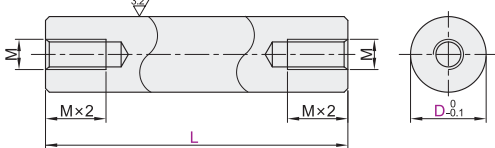

### with Wrench Flats RAD13/16/18

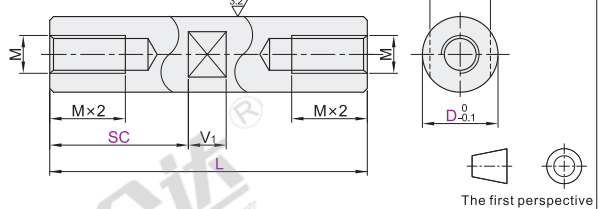

Anti-rust Oil is applied on Q235 or Equivalent products.

The first perspective

Part Number Code	0.5 mm Inc.		M (Coarse)	W	V1
	D	L			
Standard RAD03 RAD06 RAD08	5		2.6	4	
	6	8.0-60.0	3	5	10
	8	10.0-160.0	4	7	10
	10	15.0-360.0	5	8	10
	12	25.0-420.0	6	10	10
	15	25.0-520.0	8	13	12
	20	30.0-520.0	10	17	12
	25	40.0-620.0	12	22	16
	30	50.0-720.0	16	27	16
	35	50.0-820.0	16	30	16
	40	60.0-920.0	20	36	20
	50	75.0-1020.0	24	41	20

Part Number Code	0.5 mm Inc.		1 mm Inc. SC	M (Coarse)	W	V1
	D	L				
with Wrench Flats RAD13 RAD16 RAD18	5			2.6	4	
	6	10.0-60.0	0-50	3	5	10
	8	10.0-160.0	0-150	4	7	10
	10	15.0-360.0	0-350	5	8	10
	12	25.0-420.0	0-408	6	10	10
	15	25.0-520.0		8	13	12
	20	30.0-520.0	0-508	10	17	12
	25	40.0-620.0	0-610	12	22	16
	30	50.0-720.0	0-705	16	27	16
	35	50.0-820.0	0-805	16	30	16
	40	60.0-920.0	0-900	20	36	20
	50	75.0-1020.0	0-1000	24	41	20



## with Wrench Flats

Part Number Code	0.5 mm Inc.		1 mm Inc.
D	L	SC	
RAD13	5		
RAD16	6	10-60	0-50

RAD16 — D6 — L60 — SC25



Discount price	Delivery
Per 1~4 5~ Price 100% Additional quotation	6



6