

Stop Pins

- Press-Fit Type
- Screw Type

Press-Fit Type

Code	Type	Material		Hardness	Surface Treatment
		GB	Equiv.		
PAC01	Press-Fit Type	45	S45C	40~45HRC	Electroless Nickel Plating
PAC06		9Cr18Mo	SUS440C		

Slight Chamfering

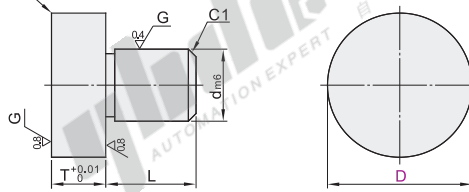

6.3



Stainless Steel Type may be discolored by hardening.

Part Number		D	d _{m6}	L	T
PAC01 PAC06	5	5		5	5
	5A	3	+0.008 +0.002	7	
	5B	5		5	3
	6	6		6	5
	6A	4		9	
	6B	6		6	3
	8	8		8	5
	8A	5	+0.012 +0.004	12	
	8B	8		8	3
	10	10		10	5
	10A	6		12	
	10B	8		8	3
	12	12		10	
	12A	8		15	
	16	16		10	5
	16A	10	+0.015 +0.006	15	
	18	18		12	5
	18A	10		12	
	20	20		16	
	20A	12	+0.018 +0.007	24	



Part Number		d _{m6}
Code	D	
PAC01	5	
	5A	
	5B	

PAC01—D5B



Discount price

Per	1~20	21~
Price	100%	Additional quotation



Delivery
6

Screw Type

Code	Type	Material		Hardness	Surface Treatment
		GB	Equiv.		
PAC51	Screw	T Fixed	35CrMo	SCM435	Electroless Nickel Plating
PAC56		T Configurable	9Cr18Mo	SUS440C	—
PAC71	Type	T Fixed	35CrMo	SCM435	Electroless Nickel Plating
PAC76		T Configurable	9Cr18Mo	SUS440C	—

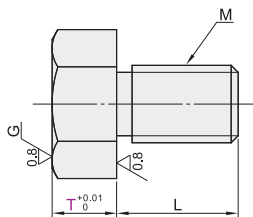

6.3



Stainless Steel Type may be discolored by hardening.

T Fixed

Part Number		T	M	L
PAC51 PAC56	5.5	3	3	5
	5.5B			
	7	5	4	6
	8		5	
	10		6	
	10A	8		9
	13	5		10
	13A	8		12
	13B	8		12
	14	5	8	10
	14A	8		10
	14B	8		10
	17	5		12
	17A	10		12
	17B	8		12
	19	5		15
	19A	8	12	18
19B	8		18	

T Configurable

Part Number		T	M	L
Code	B	0.5 mm Inc.		
PAC71 PAC76	5.5		3	5
	7	2.0~10.0	4	
	8		5	
	10		6	6
	13	5.0~30.0	8	10
	14			
	17	10.0~50.0	10	12
	19		12	15



T Fixed

Part Number	B	T
PAC51	5.5	3
PAC56	7	5

PAC51—B5.5



Discount price

Per	1~20	21~
Price	100%	Additional quotation



Delivery
6