



Code	Type	Material	I.D. (Tol.)	O.D. (Tol.)
OFM01	Straight with Oil Groove	High Tensile Brass Alloy(SP2) Solid Lubricant Embedded (Graphite)	F7	m6

#### Features

- Self-lubricating, maintenance-free, with a stable low friction coefficient under heavy load and low-speed movement.
- Excellent wear-resistance, applicable for linear and rotary movement.
- High and low temperature resistance, strong impact resistance.
- There is an oil groove inside to store the lubricating oil.

① The shaft diameter tolerances that match this product: d8 heavy load, e7 light load, g6 high precision (for reference only).

② When the product is pressed into the seat hole, put on a little lubricating oil on the end or inner wall of the seat hole, and use a hydraulic press or vise to slowly press it into the seat hole. Do not hit the product hard to avoid deformation of the product.

Detail of A (Both Sides)

L=10~25

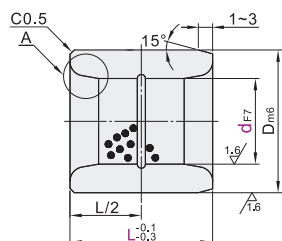

L=30~40

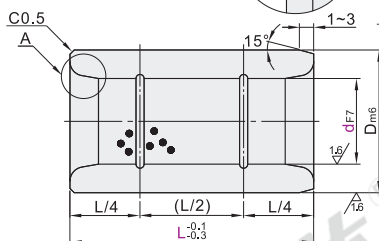

Rotation Stopper Screw

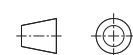
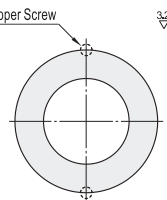

③ The Tolerance of housing diameter matching with this product: H7 (for reference only).

The first perspective

Part Number		L		D <sub>m6</sub>		R	Rotation Stopper Screw
Code	d <sub>F7</sub>	One Groove (Center)		Two Grooves			
OFM01	10	10	12 15 16 20	14	+0.018 +0.007	0.5	
	12	10	12 15 16 20	18			
	13	10	12 15 16 20 25	19		1	M4×8
	15		12 15 16 20 25	21	+0.021 +0.008		
	16		12 15 16 20 25	22			
	20		12 15 16 20 25	30 40			
	25		15 16 20 25	30 40		1.5	M5×8
	30		16 20 25	30 40	+0.025 +0.009		



Please order as shown

Part Number		L
Code	d	
OFM01	10	10 12 15
	12	12 15

OFM01—d10—L12



Discount price	
Per	Price
1~29	100%
30~	Additional quotation



Delivery	
	8